

INSTALLATION GUIDE

The material our battens are made of a HDPE (High Density Polyethylene) plastic, the same plastic that five gallon buckets are made of. It's a strong durable plastic. The plastic has a UV inhibitor added to it to extend the life of the battens. The plastic is a recyclable product making it an environmentally friendly product. The material is easy to machine, if a few inches need to be trimmed off the back end of the back batten so it fits to your crate it can easily be cut using a band saw, a cutoff saw, or a table saw. I've found that I prefer the table saw since it leaves such a nice straight clean edge.

Screw guides go all the way down to the plywood surface for a positive connection (battens will not shift)

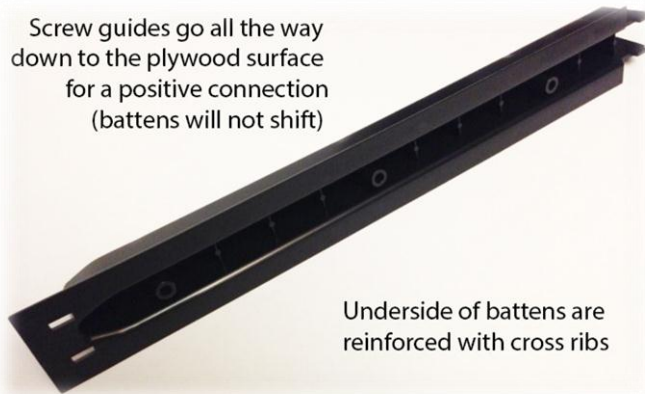

Underside of battens are reinforced with cross ribs

Image # 1 – showing the underside of the batten.

Installation process lay down your first row of battens to see how they fit, working from back to front. Once you've worked out the total length of the batten you can start screwing down the battens as you go. If you are using a battery powered screw gun with a clutch, adjust it so that the screw goes down all the way drawing the batten down tightly to the wood. A spacer can be used to simulate the thickness of your properties (like a panel). Add 1/8" to the spacer to give you some play when sliding the panels or other properties into the crate.

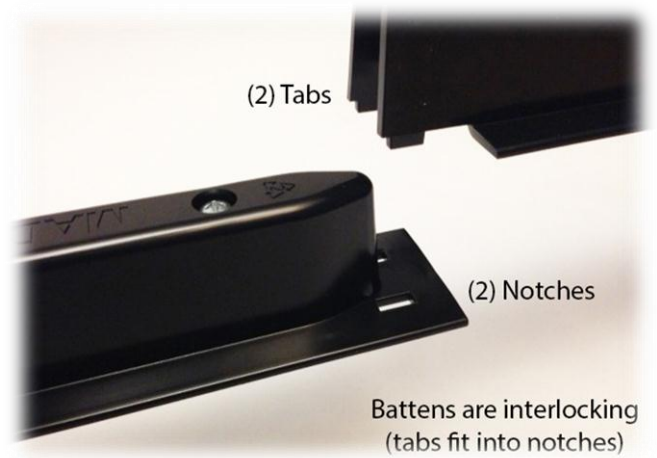

(2) Tabs

(2) Notches

Battens are interlocking (tabs fit into notches)

Image # 2 – showing how the battens interlock.

If a batten has been screwed into a crate in the exact same location several times (as in a rental crate) the wood may not hold the screw for the batten like it should, this can easily be worked around by trimming a half inch off the back of the back batten in that row which causes all the batten pieces in that row to shift back providing a new positive secure connection to the crate.



Stainless steel screws are included with battens

Image # 3 – Shows the battens in a crate being installed.

LARGE KIT CONTAINS

- (66) Black battens
 - (200) 2" long, # 10, Zinc Plated Combination Drive, Pan Head Screws
 - (1) Installation Guide
-

SMALL KIT CONTAINS

- (33) Black battens
 - (100) 2" long, # 10, Zinc Plated Combination Drive, Pan Head Screws
 - (1) Installation Guide
-

Disclaimer: this product has been designed for use as a trade show crating batten (internal runner) to hold panels and other exhibit materials in place during shipment and while in storage to prevent crated objects from shifting and getting damaged. If used as intended they will work properly for a very long time.

Professional Crating Solutions

Willow Springs, IL. 60480 USA

Phone: (708) 294-2002

www.pro-crating.com